

# Garrett Collection (0035) Replacement Parts

CF1002-BBS  
CF1002-PN

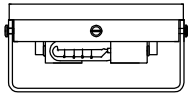

CF1032-BBS  
CF1032-PN

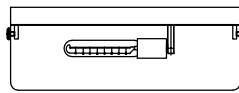

CW1001-BBS  
CW1001-PN

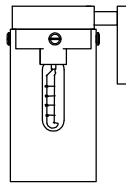

CW1003-BBS  
CW1003-PN

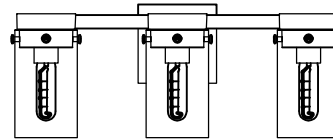

CW1004-BBS  
CW1004-PN

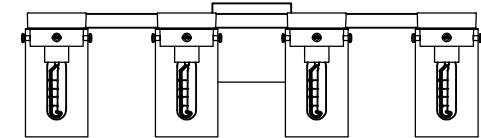

CW1002-BBS  
CW1002-PN

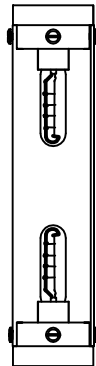

CP1121-BBS  
CP1121-PN

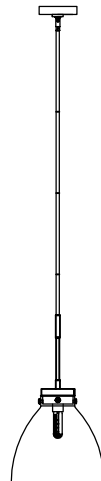

CP1001-BBS  
CP1001-PN

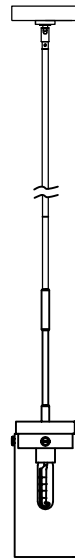

CP1011-BBS  
CP1011-PN

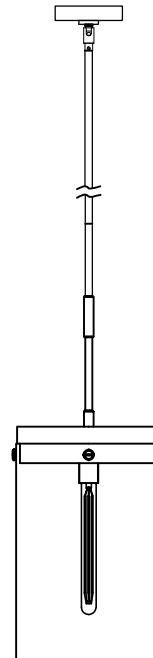

CT1001-BBS1  
CT1001-PN1

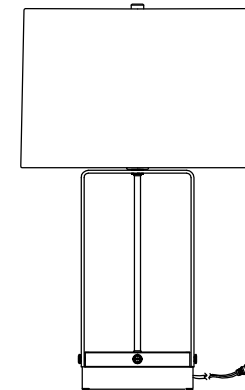

# Garrett Collection (0035) Replacement Parts

Part Number	Description	Used On
CKA0035-XXX	Canopy kit includes canopy, 1/8 I.P. RTN, Mtg bar, hex nut(2), screw collar set, swivel	CP1001,CP1121
CKB0035-XXX	Canopy kit includes canopy, 1/4 I.P. RTN, Mtg bar, hex nut(2), screw collar set, swivel	CP1011
HB0035-XXX	Hardwares Bag, for Garrett collection	For Garrett collection
STEMKIT-12-XXX	Accessory stem kit including $\phi 1/2"$ X 12"(3pcs) & $\phi 1/2"$ X 6"(1pc)	CP1001,CP1121
STEMKIT-58-XXX	Accessory stem kit including $\phi 5/8"$ X 12"(3pcs) & $\phi 1/2"$ X 6"(1pc)	CP1011
HARP9.5-XXX	Shade harp H9-1/2"	CT1001
GLA0035	Glass, $\phi 11"$ ,4-1/2" Height, Clear	CF1002
GLB0035	Glass, $\phi 5"$ ,10" Height, Clear	CP1001
GLC0035	Glass, $\phi 11-3/4"$ ,17-1/2" Height, Clear	CP1011
GLD0035	Glass, $\phi 5"$ ,8-7/8" Height, Clear	CW1001
GLE0035	Glass,H16",W4",Height, Clear	CW1002
GLF0035	Glass, $\phi 18"$ ,5-1/8" Height, Clear	CF1032
GLG0035	Glass, $\phi 13-1/2"$ ,12-1/2" Height, Clear	CP1121
GLH0035	Glass, $\phi 4"$ ,6-7/8" Height, Clear	CW1003,CW1004
DIFFUSER0035	Fabric Diffuser, $\phi 450$ mm	CT1001
SH0035	Fabric Shade,( $\phi 18-1/2"$ + $\phi 19"$ ),13"Height,VC white linen shade rolled edge	CT1001

Part number & detail:

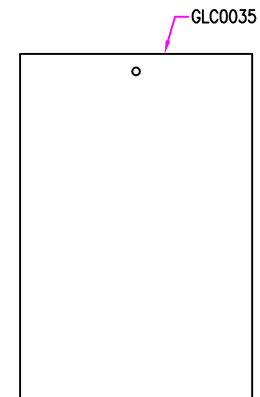
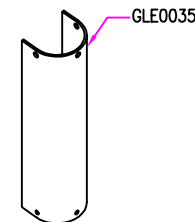
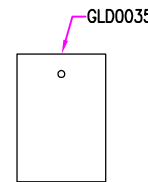
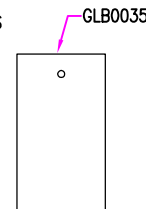
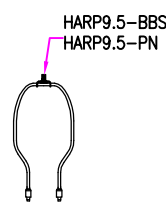
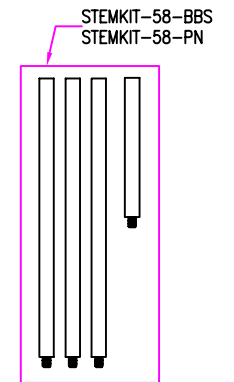
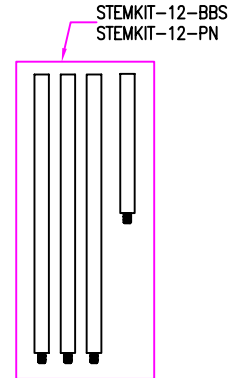
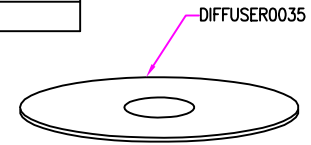
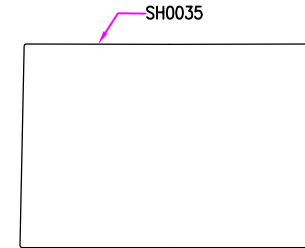
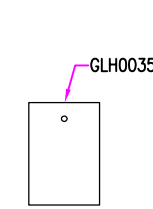
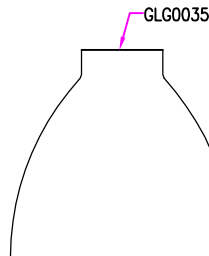
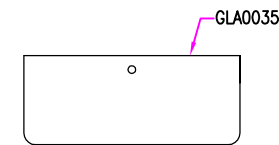
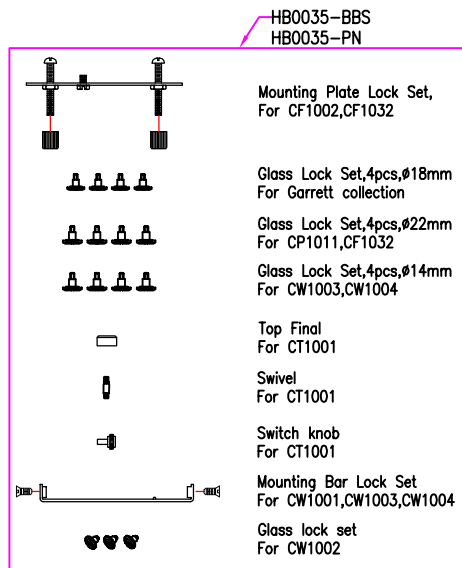
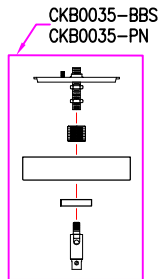
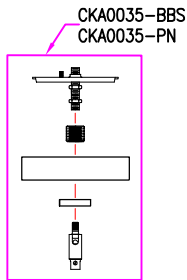

**GENERATION LIGHTING**