

# Assembly Instructions For

# WBES4500 (E) 5/09

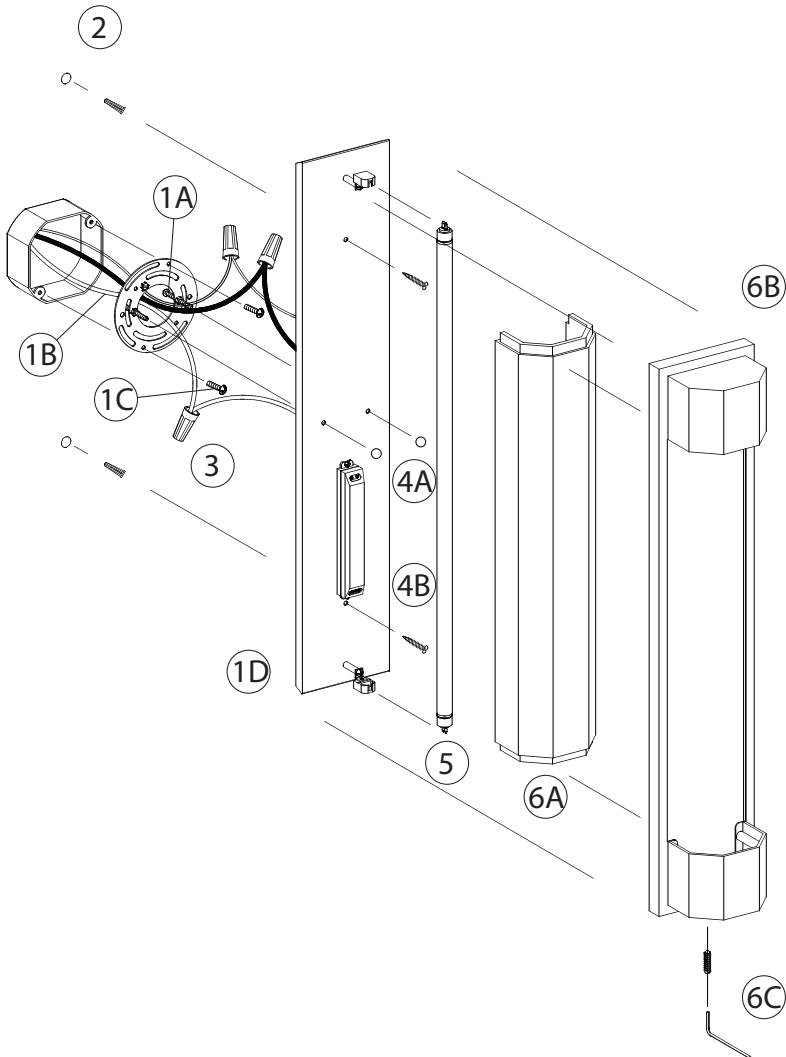

## IMPORTANT

### TURN OFF THE POWER AT THE MAIN FUSE OR CIRCUIT BREAKER BOX BEFORE STARTING INSTALLATION

Carefully unpack and identify all parts before assembly. Bulbs not included.

1. Install mounting plate:
  - A. Fasten two long machine screws (supplied) onto the mounting plate (from the side opposite of green grounding screw head). **NOTE:** Install onto holes corresponding with fixture plate mounting holes.
  - B. Take supply wires from wall outlet box and carefully pass them through center hole of mounting plate.
  - C. Install mounting plate onto the outlet box using two screws supplied with outlet box.
  - D. Test install fixture plate to make certain about 1/4" (5mm) of screws thread protrude outside of fixture plate. If not then remove fixture plate and adjust screws length accordingly. Secure screws length by fastening with two hex nuts. Make certain not to spin screws during fastening.
2. Install anchor (included):
  - A. Test install fixture plate onto the two long machine screws. Then while the fixture plate is leveled vertically, use a pen or pencil to make a mark on the wall at holes located near each end of fixture plate.
  - B. Remove the fixture plate and set aside.
  - C. Drill marked spots. If drywall or masonry wall then use 1/4" (7 mm) drill bit; if wood wall then use 1/8" (4 mm) drill bit.
  - D. Drywall or masonry wall only: Insert plastic anchor into pre-drilled holes.
3. Connect electrical wires:
  - A. Connect white fixture wire(s) to white supply wire from outlet box with wire connector. Connect black fixture wire(s) to black supply wire from outlet box with wire connector. **NOTE:** Black outlet box wire may be red, round and smooth and/or have copper conductor. White outlet box wire may be square and ridged and/or have a silver conductor.
  - B. Connect fixture ground wire (without plastic insulation) to ground wire from outlet box (usually with green insulation) with wire connector. **Note:** If there is no supply ground wire at outlet box then attach fixture ground wire securely onto green grounding screw located at mounting plate. **IMPORTANT:** Never connect ground wire to black or white supply wires (from outlet box).
4. Install fixture plate:
  - A. Install fixture plate onto mounting plate by fastening with two cap nuts.
  - B. Secure fixture plate onto pre-drilled holes using sheet metal screws (included).
5. Install T5, 14 Watt, 22" length fluorescent lamp (included).
6. Install fixture:
  - A. Gently insert glass shade inside of fixture frame.
  - B. Hook top of fixture frame onto top edge of fixture plate.
  - C. Then secure fixture frame onto bottom of fixture plate by fastening set screw. Use provided hex key to tighten.



**MURRAY**  
**FEISS**  
Generation Brands™