

Assembly Instructions For **VS12902** (E) 10/07

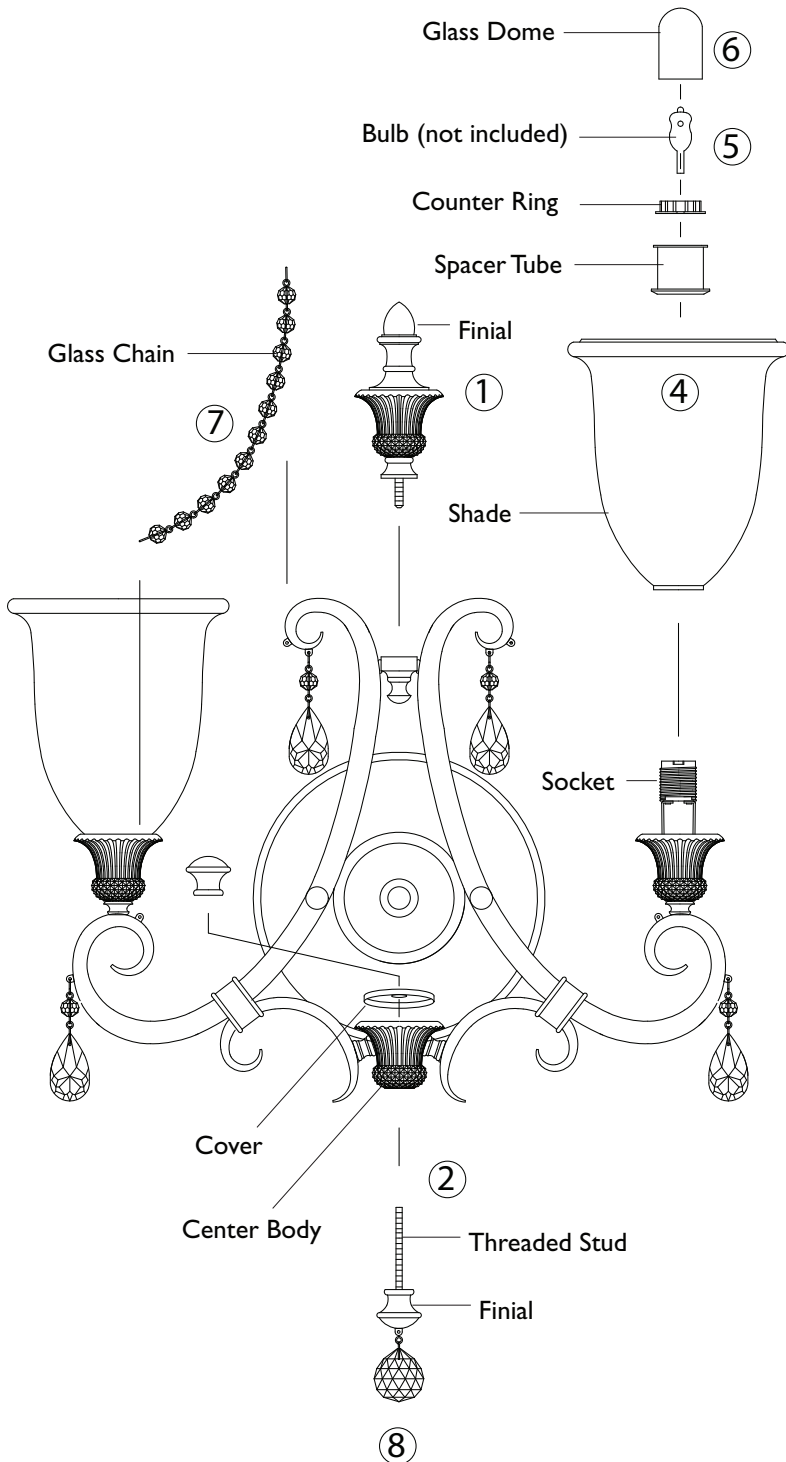

IMPORTANT **TURN OFF THE POWER AT THE MAIN FUSE OR** **CIRCUIT BREAKER BOX** **BEFORE STARTING INSTALLATION**

Carefully unpack and identify all parts before assembly.
Bulbs not included.

1. Install finial onto top of fixture.
2. Insert threaded stud by screwing into finial. Then insert threaded stud through center body and cover (open side facing down). Secure all together by fastening with another finial from above.
3. Follow enclosed supplement installation instructions for electrical and fixture installation onto house outlet box. If you do not have an outlet box at desired location to attach the fixture than hire a qualified electrician to create one.
4. Place shade over threaded socket then spacer ring and secure with counter ring.
5. Install bulbs (not included). See relamping label located near socket area for type and maximum allowed wattage.
NOTE: Make certain not to handle lamp with bare hand since this will cause lamp to shatter at high heat. Handle with clean soft cloth.
6. Install glass dome by screwing onto socket.
7. Install glass chain by hooking onto curls located at top and bottom section of arm. Repeat other side.
8. Hang all crystal glass parts as shown on drawing.
NOTE: To replace broken crystals extras are included in hardware bag. Replace by gently bending open pin, remove broken crystal, hook new one, then close back pin. Avoid bending pin into sharp angle.

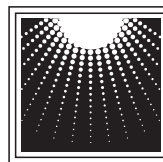

MURRAY
FEISS

Generation Brands™