

# Bantry House Chandelier

AC1004, AC1014, AC1024, AC1038, AC1046 1.0

GENERATION LIGHTING

## Chandelier

### GENERAL PRODUCT INFORMATION:

These fixtures are intended to be installed utilizing NEC compliant junction boxes.

This product is safety listed for damp locations.

Incandescent lamps may be dimmed with a standard incandescent dimmer. LED lamps may be dimmed with a LED dimmer. Consult lamp manufacturer for additional information.

This instruction shows a typical installation.

### CAUTION - RISK OF FIRE

This product must be installed in accordance with the applicable installation code by a person familiar with the construction and operation of the product and the hazards involved.

Use minimum 90°C supply conductors.

GENERATION LIGHTING

7400 Linder Ave, Skokie, IL 16077

800.969.3347

[www.generationlighting.com](http://www.generationlighting.com)

© 2019 Generation Lighting. All rights reserved.

The "Generation Lighting" graphic is a registered trademark of Generation Lighting. Generation Lighting reserves the right to change specifications for product improvements without notification.

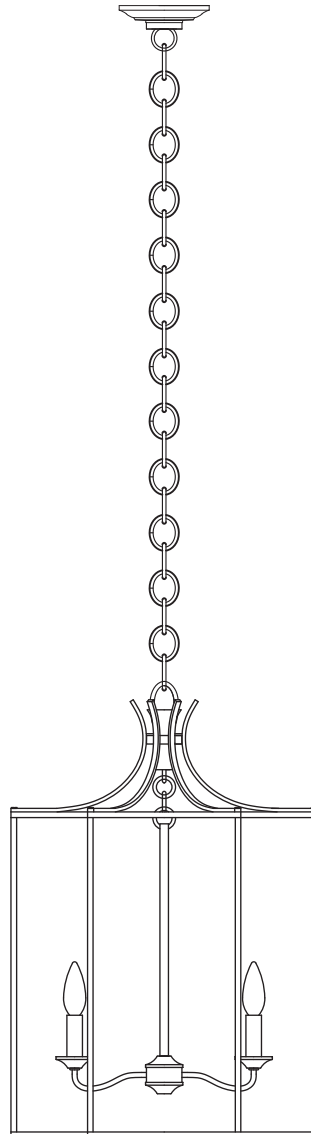

**SAVE THESE INSTRUCTIONS!**

# Install the Fixture

IA

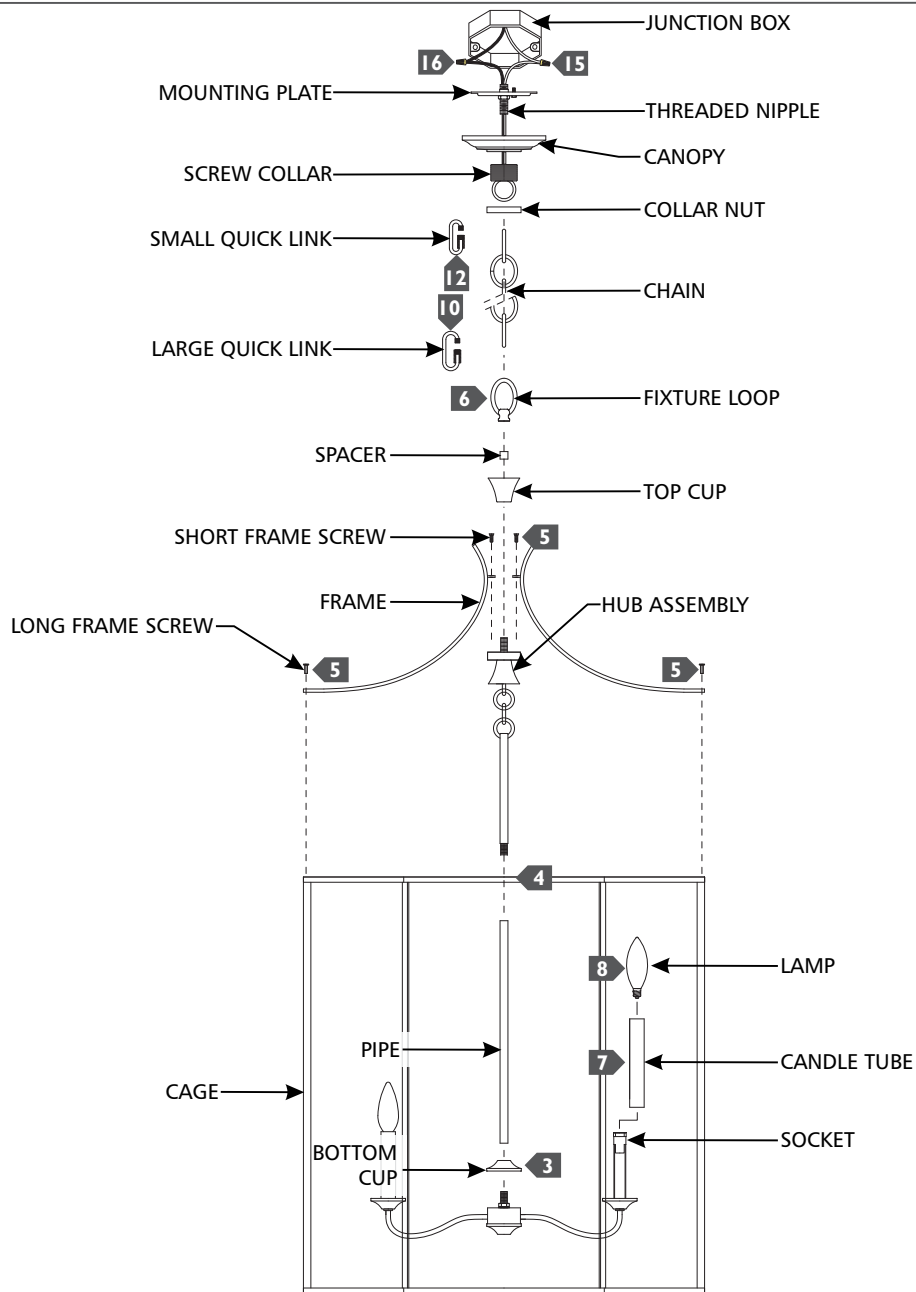

- 1** If necessary, screw the short end of the threaded nipple tightly onto the mounting plate and the screw collar onto the threaded nipple.
- 2** Secure the mounting plate to the junction box.
- 3** Feed the cord through the bottom cup and pipe, then screw the pipe onto the fixture.
- 4** Feed the cord through the hub assembly, then screw it onto the pipe.
- 5** Install the frames to the top of the hub assembly using the short frame screws and to the top of the cage using the long frame screws as shown.
- 6** Feed the cord through the top cup and spacer, then secure them in place by screwing the fixture loop onto the hub assembly.
- 7** Install the candle tubes by sliding them over the sockets.
- 8** Screw the lamps into the sockets. Refer to the label on the lamp socket for Max Wattage information.
- 9** Determine the wanted height of the fixture and remove a portion of the chain from the bottom by opening a link with pliers.
- 10** Install the large quick link to bottom end of the chain, then secure the large quick link onto the fixture loop.
- 11** Unscrew the collar nut from the screw collar, then install the collar nut and the canopy onto the chain (in that order).
- 12** Install the small quick link onto the remaining end of the chain, then secure the small quick link onto the screw collar.
- 13** Weave the cord through the chain, canopy, screw collar, threaded nipple, and out of the junction box. Trim the cord leaving enough to make electrical connections.
- 14** Connect the fixture to a suitable ground in accordance to local electrical codes.
- 15** Connect the white fixture wire (square and/or rigid) to the neutral power line wire with a wire nut.
- 16** Connect the black fixture wire (round and/or smooth) to the hot power line wire with a wire nut.
- 17** Neatly place all the wires into the junction box, place the canopy onto the mounting plate, and secure it in place by screwing the collar nut tightly onto the screw collar.